

PRO-SOURCE® Air-Over-Water Tanks

Steel, epoxy-lined



The Pro-Source® Epoxy-Lined Tank is an excellent corrosion-resistant tank available in a variety of sizes for use in water systems applications, as a retention tank or holding tank. This tank utilizes an electrostatic paint process, resulting in superior rust protection.

APPLICATIONS

For use as a standard water tank, retention tank or holding tank.

SPECIFICATIONS

Shell: Heavy-gauge steel
Skirt: Heavy-gauge steel
Interior Coating: Epoxy
Fittings: Machined steel
Finish: Baked-on polyester paint

ORDERING INFORMATION

Catalog Number	Capacity U.S. Gal.	Style	Tank Diameter	Tank Height	Tank Length	Approx. Weight Lbs.	Maximum Operating Pressure (PSI)
AW30H	30	Horizontal	16"	17-1/2"	36-1/2"	55	75
AW42	42	Vertical	20"	36-5/8"	N/A	67	75
AW42T	42	Vertical	16"	53-1/2"	N/A	65	75
AW85	85	Vertical	24"	51"	N/A	94	75
AW120	120	Vertical	24"	68"	N/A	120	75

Max liquid temperature = 120 deg F

Max Operating Pressure = 75 PSI

FEATURES

Quality Construction: The precision press fit head and wrapper minimize the possibility of large gaps between components. This manufacturing process reduces the possibility of corrosion and seam leaks.

Heavy-Gauge Steel: Sturdy construction is emphasized, with heavier gauge steel than most tanks. This minimizes the possibility of dents from mishandling, and rust-through.

Uniform Epoxy Coating: The insides of the tanks are electrostatically powder-coated and then are oven-baked to ensure proper adhesion and consistent coverage. This paint process offers superior corrosion resistance over traditional wet paints.

Appliance-Like Exterior Finish: A polyester paint is also electrostatically adhered to the outer surface and then baked on for a high-gloss appearance.

Flush Mount Fittings: Designed to solve one of the toughest corrosion problems, these fittings eliminate flanges and sharp angles that make paint adherence difficult.

Standard Top Mount Fitting: Facilitates use as a retention tank, or for hard-to-fit areas. This fitting can also be used for an optional jet mount package.

Sturdy Base: Bases for horizontal models are constructed of heavy-gauge steel, with slots for ventilation to avoid condensation problems.

PRO-SOURCE® Air-Over-Water Tanks

Steel, epoxy-lined

VERTICAL OUTLINE DIMENSIONS

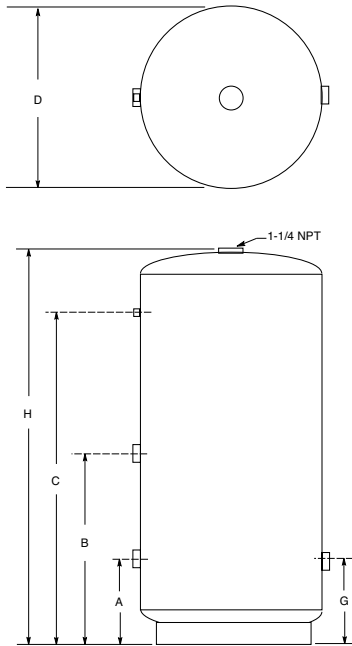

Dimensions (in inches) are for estimating purposes only.

HORIZONTAL OUTLINE DIMENSIONS

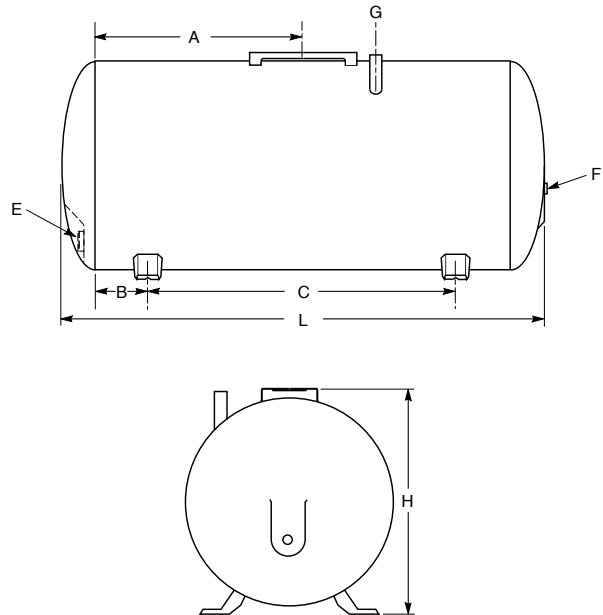

Dimensions (in inches) are for estimating purposes only.

DIMENSIONAL DATA

VERTICAL EPOXY-LINED TANKS

Catalog Number	Gallons	Dimensions in Inches									
		D Dia.	H Ht.	A Dist.	A Size	B Dist.	B Size	C Dist.	C Size	G Dist.	G Size
AW42	42	20	36-5/8	8-1/2	1-1/4	19-1/2	1-1/4	27-3/4	1/4	8-1/2	1-1/4
AW42T	42	16	53-1/2	8	1-1/4	28	1-1/4	45	1/4	8	1-1/4
AW85	85	24	51	12	1-1/4	26-1/8	1-1/4	40-7/8	1/4	9-1/2	1-1/4
AW120	120	24	68	12	1-1/4	35	1-1/4	58-1/8	1/4	9-1/2	1-1/4

HORIZONTAL EPOXY-LINED TANKS

Catalog Number	Gallons	Dimensions in Inches						Outlet Size		
		Dia.	Length	Ht.	A	B	C	E	F	G
AW30H	30	16	36-1/2	17-1/2	13-3/4	4-3/4	22	3/4	1/4	3/4

Horizontal tanks include pump mounting bracket as standard.

Note: All pumps installed with a Pro-Source® tank require a 75 PSI relief valve. Relief valve must be capable of relieving entire pump flow at relief pressure.

TANK PERFORMANCE

Catalog Number	Capacity U.S. Gal.	Drawdown in Gallons		
		20-40	30-50	40-60
AW30H	30	5.2	4.4	3.9
AW42	42	6.7	5.8	5.0
AW42T	42	6.9	5.9	5.2
AW85	85	14.3	12.3	10.7
AW120	120	19.9	17.1	14.9



U238-5
Air Volume Controls
(Jet pump type)



E238-2
Air Volume Control
(Submersible type)



US: 293 WRIGHT STREET, DELAVAN, WI 53115 WWW.STA-RITE.COM PH: 888-782-7483 ORDERS FAX: 800-426-9446

CANADA: 490 PINEBUSH ROAD, UNIT 4, CAMBRIDGE, ONTARIO N1T 0A5 PH: 800-363-7867 ORDERS FAX: 888-606-5484

Because we are continuously improving our products and services, Pentair reserves the right to change specifications without prior notice.